

Included in the box (1 of each):

Antimicrobial Overlay

Alcohol Wipe

Microfiber Cloth

Dust Removal Sticker

Applicator Squeegee

For cleaning the antimicrobial overlay, please follow Elo's recommended cleaning procedures, found here: www.elotouch.com/support/technical-support/cleaning



Quick Installation Guide

Elo Guard™ Antimicrobial Overlay

Revision B
P/N E596418

Elo Technical Support

Online self-help: www.elotouch.com/support

America

800-ELO-TOUCH
Tel +1 408 597 8000
EloSales.NA@elotouch.com

Europe (EMEA)

Tel +32 (0)16 70 45 00
elosales@elotouch.com

Asia Pacific

Tel +86 (21) 3329 1385
EloAsia@elotouch.com

The information in this document is subject to change without notice. Elo Touch Solutions, Inc. and its Affiliates (collectively "Elo") makes no representations or warranties with respect to the contents herein, and specifically disclaims any implied warranties of merchantability or fitness for a particular purpose. Elo reserves the right to revise this publication and to make changes from time to time in the content hereof without obligation of Elo to notify any person of such revisions or changes.

No part of this publication may be reproduced, transmitted, transcribed, stored in a retrieval system, or translated into any language or computer language, in any form or by any means, including, but not limited to, electronic, magnetic, optical, chemical, manual, or otherwise without prior written permission of Elo Touch Solutions, Inc.

Elo, the Elo logo and Elo Guard are either trademarks or registered trademarks of Elo Touch Solutions, Inc.



Elo Guard™
Antimicrobial Solutions

www.elotouch.com



Installation

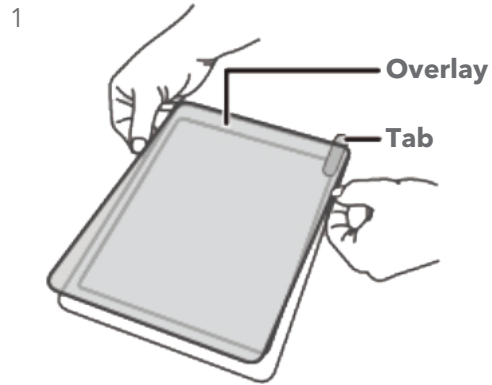

Align the overlay with your device's screen. Make sure the tab is facing the screen.

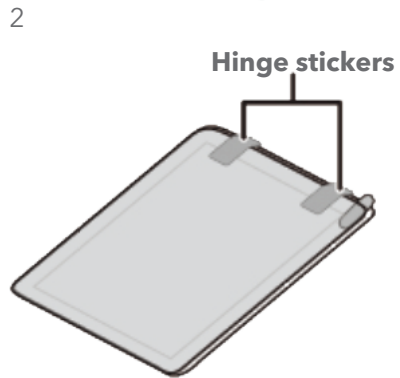

Secure the overlay at the top with the two hinge stickers.

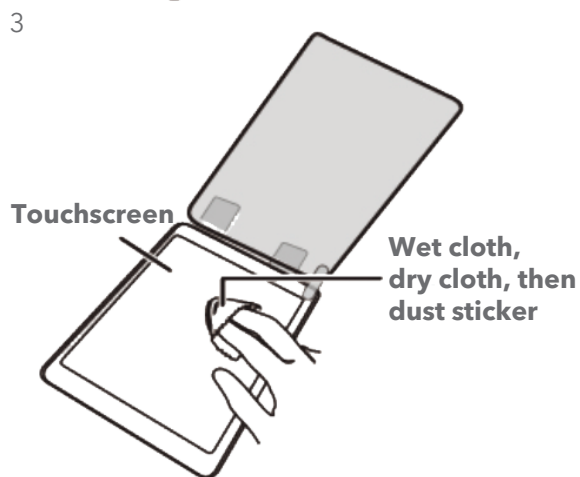

Lift up the overlay and clean the touchscreen first with the wet alcohol wipe then with the dry microfiber cloth (both included). Use the dust removal sticker (included) to clean any remaining debris. Do not use any solvents.

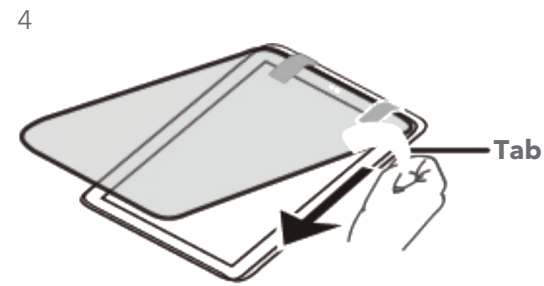

Slowly pull back the tab to remove the adhesive backing. The overlay adheres to your touchscreen.

Wait for overlay to naturally settle onto the screen surface.

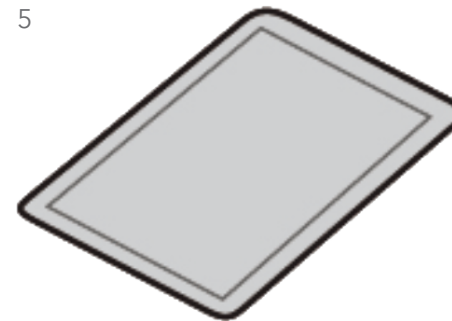

Remove the hinge stickers.

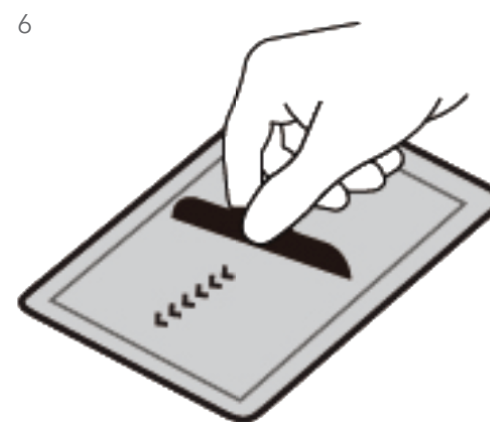

Using your finger or the applicator squeegee (included), push down evenly on the overlay to remove any air bubbles. Start from the center of the overlay and work your way to the edges. Press down and use the microfiber cloth to remove any final air bubbles at the edges.